

# STANDARD DOOR

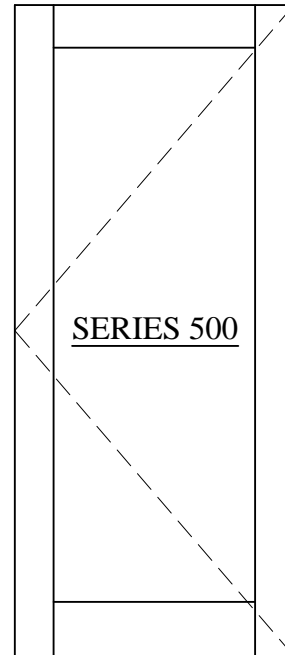

## KEY FEATURES

- 1  $\frac{3}{4}$ " door depth
- Accommodates  $\frac{1}{4}$ ",  $\frac{3}{8}$ " or 1" glazing units
- 2", 3  $\frac{1}{2}$ " and 5" stiles available
- Multiple top/bottom/mid-rails available
- Available in anodized and painted finishes
- Standard custom hardware available

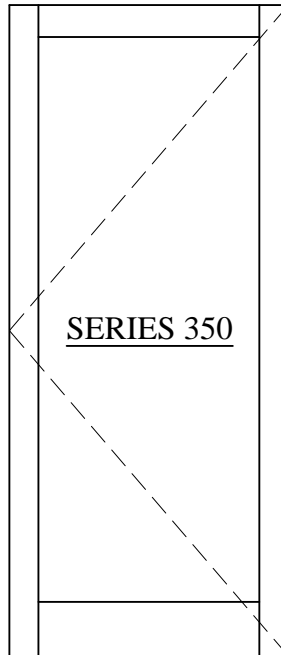
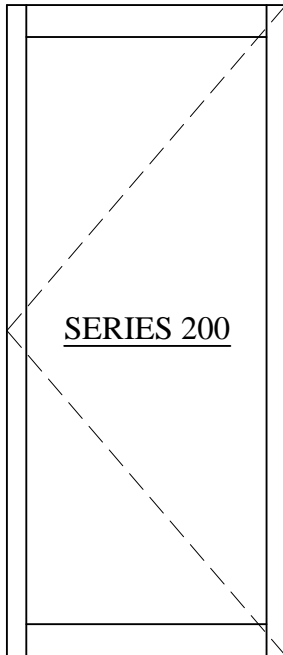

**WINDSPEC** INC.

MANUFACTURERS OF HIGH PERFORMANCE 'WINDSPEC' WINDOWS  
ALUMINUM ENTRANCE SYSTEMS AND ARCHITECTURAL PANELS  
1310 CREDITSTONE RD, CONCORD, ONTARIO L4K 5T7  
Telephone (905) 738 -8311 Fax (905) 738 - 6188

JANUARY 2016

# STANDARD DOOR

## TABLE OF CONTENTS

DOOR ORDERING INFORMATION _____	003
GLAZING INFILL OPTIONS _____	004
NARROW STILE IN HTP 5500 _____	006
MEDIUM STILE IN HTP 5500 _____	008
WIDE STILE IN HTP 5500 _____	010
NARROW STILE IN 655 FRAMING _____	012
MEDIUM STILE IN 655 FRAMING _____	014
WIDE STILE IN 655 FRAMING _____	016
SINGLE GLAZED DOOR IN INTERIOR FRAMING _____	018
TOP RAILS, MID-RAIS & BOTTOM RAILS _____	020



**WINDSPEC** INC.

MANUFACTURERS OF HIGH PERFORMANCE 'WINDSPEC' WINDOWS  
ALUMINUM ENTRANCE SYSTEMS AND ARCHITECTURAL PANELS  
1310 CREDITSTONE RD, CONCORD, ONTARIO L4K 5T7  
Telephone (905) 738 -8311 Fax (905) 738 - 6188

JANUARY 2016

# STANDARD DOOR

## DOOR ORDERING INFORMATION

### Standard Hardware

- 3 Butt hinges (NRP) - 4  $\frac{1}{2}$ " x 4"
  - Stainless steel for exterior doors
  - Standard steel for interior doors
- M.S. Lock (Adams Rite 1850)
  - Thumb turn
  - Cylinder
- Pair to have flush bolts on in-active
- Push bar / pull handle
- 4" threshold
- Door sweep

### Standard Door Opening Size

- Door opening for single door is 36" x 84"
- Door opening for pair door is 72" x 84"
- Actual door size will be smaller to allow for clearances

### Standard Finishes

- Standard anodized doors:
  - Clear 0.0004 and #40 Bronze are typically stocked
  - Light bronze, champagne and black anodized are available
- Custom painted finishes are available

### Door Swings

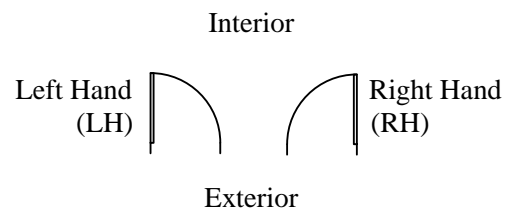
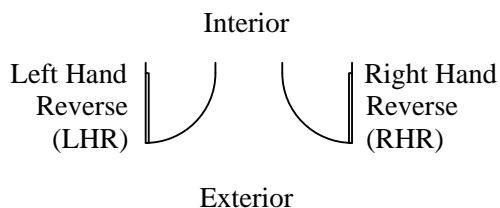







**WINDSPEC** INC.

MANUFACTURERS OF HIGH PERFORMANCE 'WINDSPEC' WINDOWS  
ALUMINUM ENTRANCE SYSTEMS AND ARCHITECTURAL PANELS  
1310 CREDITSTONE RD, CONCORD, ONTARIO L4K 5T7  
Telephone (905) 738 -8311 Fax (905) 738 - 6188

JANUARY 2016

# STANDARD DOOR

## GLAZING INFILL OPTIONS

Glazing Options	Exterior Glass Stop	Interior Glass Stop
1" Glazing (Double Glazed)	 C-20027	 C-20027
$\frac{1}{4}$ " Glazing (Single Glazed)	 C-20026	 C-20026
$\frac{3}{8}$ " Glazing	 C-20019	 C-20019

### GLASS SIZE CALCULATION

**\*\*Based on butt hinges at 1/2" threshold\*\***

Door Type	Glass W	Glass H	Standard Glass Size (36" x 84")
<u>200 Single</u>  (2" Stile, 2 $\frac{3}{8}$ " Top, 4 $\frac{1}{8}$ " Bottom Rail)	-4 $\frac{11}{16}$ "	-7 $\frac{13}{16}$ "	31 $\frac{5}{16}$ " x 76 $\frac{3}{16}$ "
<u>200 Pair</u>  (2" Stile, 2 $\frac{3}{8}$ " Top, 4 $\frac{1}{8}$ " Bottom Rail)	2 x -4 $\frac{11}{16}$ "	-7 $\frac{13}{16}$ "	2 @ 31 $\frac{5}{16}$ " x 76 $\frac{3}{16}$ "



**WINDSPEC** INC.

MANUFACTURERS OF HIGH PERFORMANCE 'WINDSPEC' WINDOWS  
ALUMINUM ENTRANCE SYSTEMS AND ARCHITECTURAL PANELS  
1310 CREDITSTONE RD, CONCORD, ONTARIO L4K 5T7  
Telephone (905) 738 -8311 Fax (905) 738 - 6188

JANUARY 2016

# STANDARD DOOR

## GLAZING INFILL OPTIONS

Door Type	Glass W	Glass H	Standard Glass Size (36" x 84")
<u>350 Single</u> (3 ½" Stile, 4 ⅛" Top, 7" Bottom Rail)	-7 ⅙"	-12 ⅞"	28 ⅝" x 71 ⅙"
<u>350 Pair</u> (3 ½" Stile, 4 ⅛" Top, 7" Bottom Rail)	2 x -7 ⅙"	-12 ⅞"	2 @ 28 ⅝" x 71 ⅙"
<u>500 Single</u> (5" Stile, 5 ½" Top, 7" Bottom Rail)	-10 ⅙"	-13 ⅙"	25 ⅝" x 70 ⅜"
<u>500 Pair</u> (5" Stile, 5 ½" Top, 7" Bottom Rail)	2 x -10 ⅙"	-13 ⅙"	2 @ 25 ⅝" x 70 ⅜"



**WINDSPEC** INC.

MANUFACTURERS OF HIGH PERFORMANCE 'WINDSPEC' WINDOWS  
ALUMINUM ENTRANCE SYSTEMS AND ARCHITECTURAL PANELS  
1310 CREDITSTONE RD, CONCORD, ONTARIO L4K 5T7  
Telephone (905) 738 -8311 Fax (905) 738 - 6188

JANUARY 2016

# STANDARD DOOR

## NARROW STILE IN HTP 5500

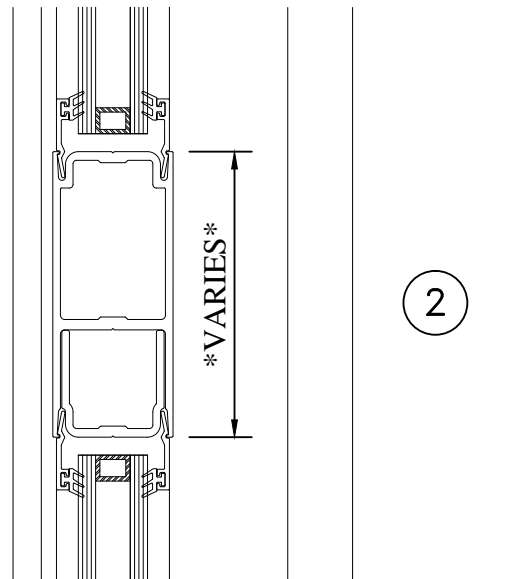
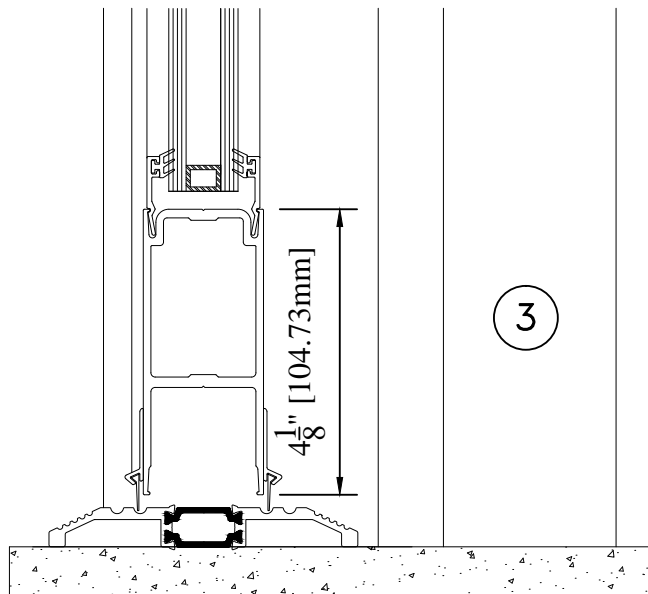
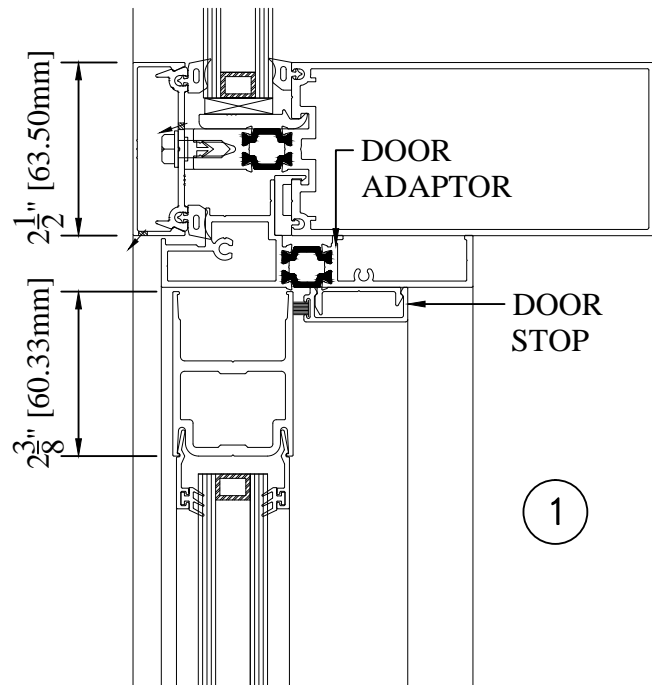
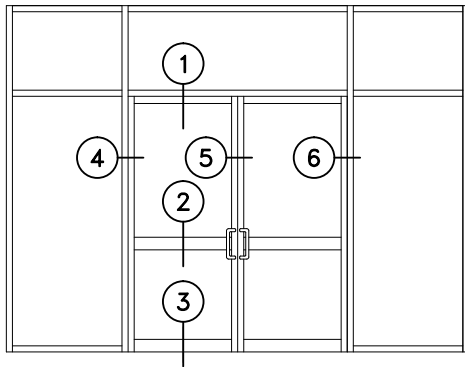

**WINDSPEC** INC.  
MANUFACTURERS OF HIGH PERFORMANCE 'WINDSPEC' WINDOWS  
ALUMINUM ENTRANCE SYSTEMS AND ARCHITECTURAL PANELS  
1310 CREDITSTONE RD, CONCORD, ONTARIO L4K 5T7  
Telephone (905) 738 -8311 Fax (905) 738 - 6188

JANUARY 2016

# STANDARD DOOR

## NARROW STILE IN HTP 5500

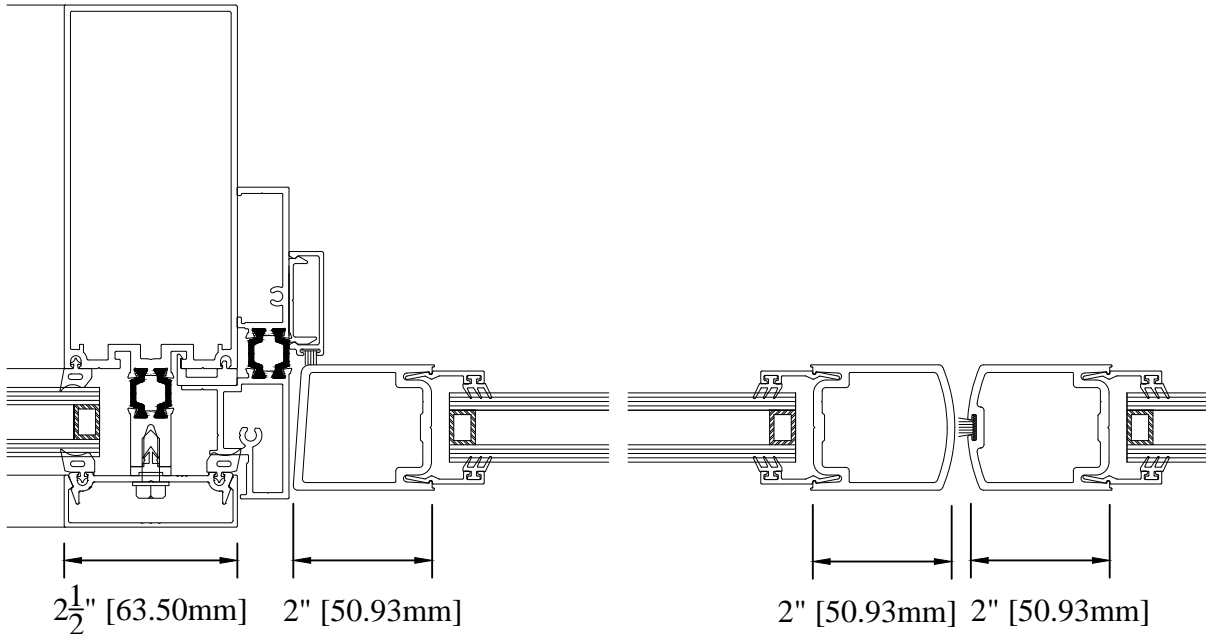

4

5

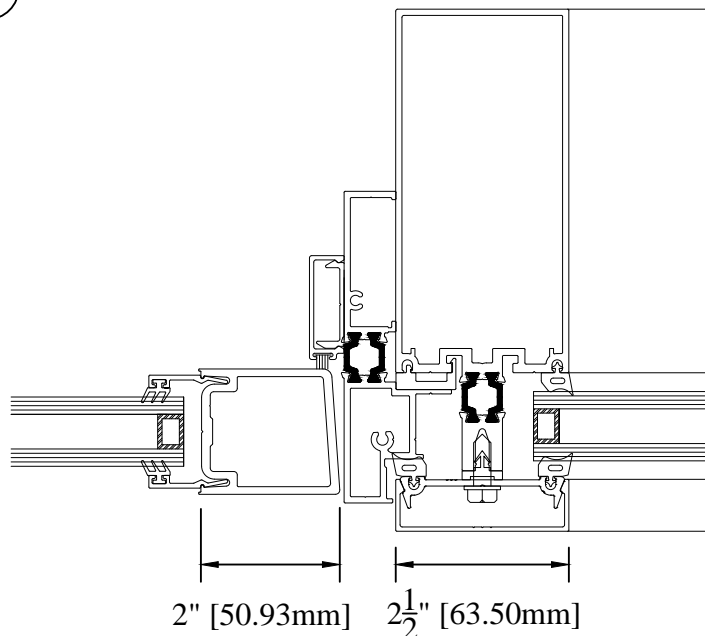

6



**WINDSPEC** INC.

MANUFACTURERS OF HIGH PERFORMANCE 'WINDSPEC' WINDOWS  
ALUMINUM ENTRANCE SYSTEMS AND ARCHITECTURAL PANELS  
1310 CREDITSTONE RD, CONCORD, ONTARIO L4K 5T7  
Telephone (905) 738 -8311 Fax (905) 738 - 6188

JANUARY 2016

# STANDARD DOOR

## MEDIUM STILE IN HTP 5500

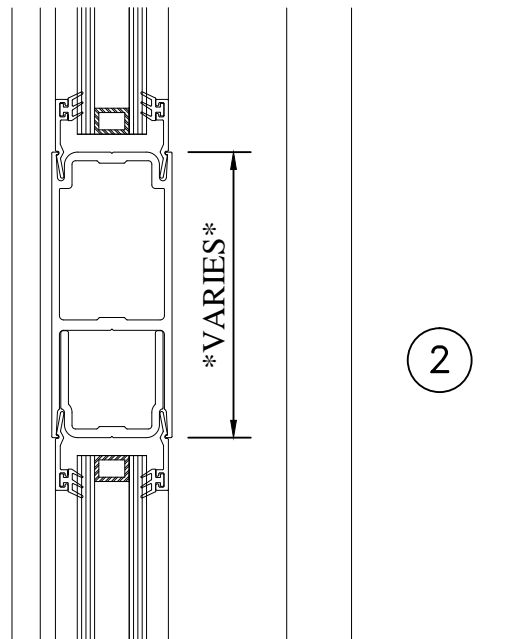
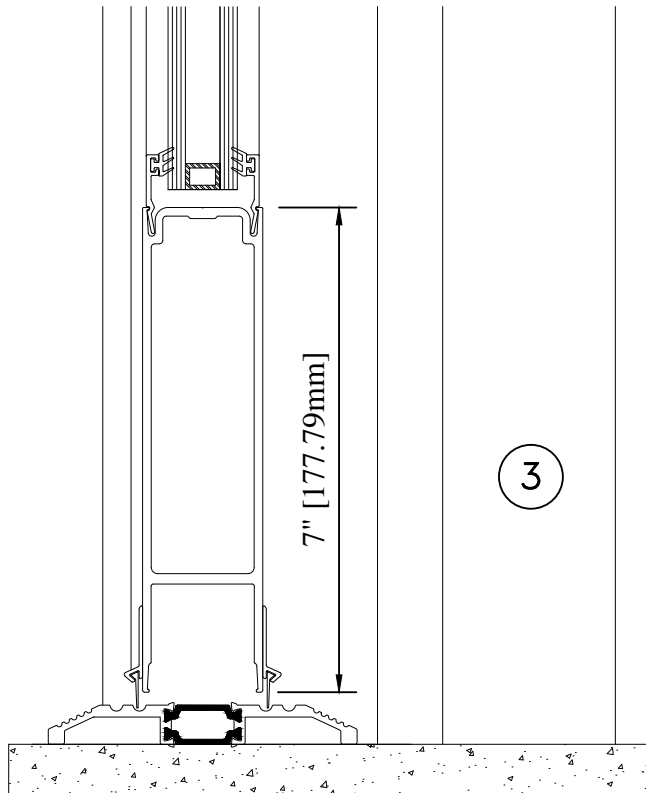
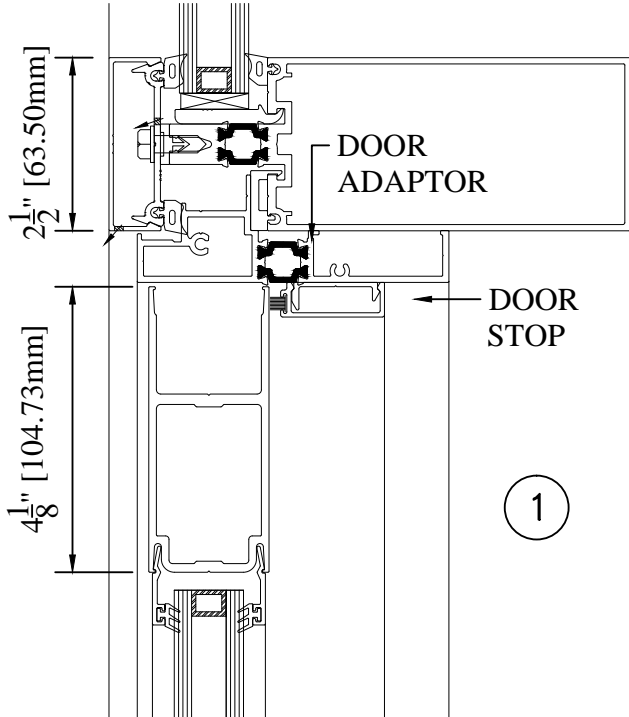
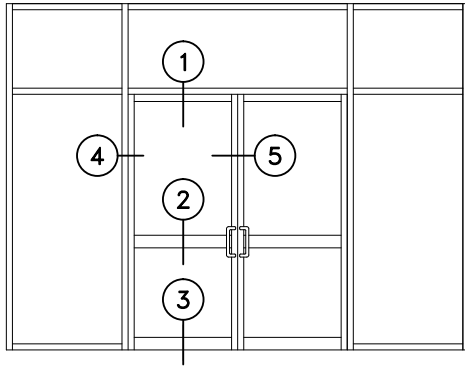

**WINDSPEC** INC.

MANUFACTURERS OF HIGH PERFORMANCE 'WINDSPEC' WINDOWS  
ALUMINUM ENTRANCE SYSTEMS AND ARCHITECTURAL PANELS  
1310 CREDITSTONE RD, CONCORD, ONTARIO L4K 5T7  
Telephone (905) 738 -8311 Fax (905) 738 - 6188

JANUARY 2016



# STANDARD DOOR

## MEDIUM STILE IN HTP 5500

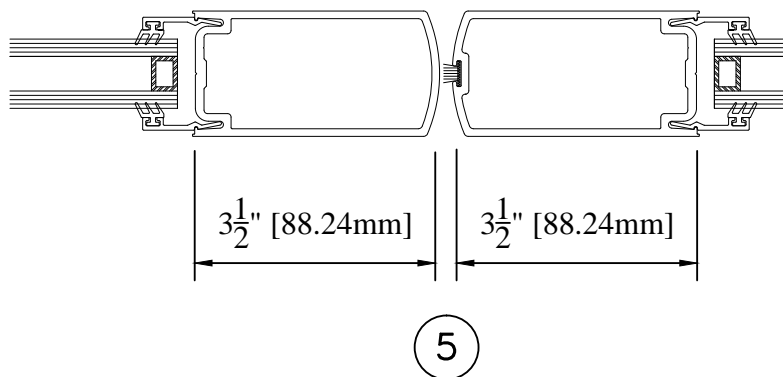
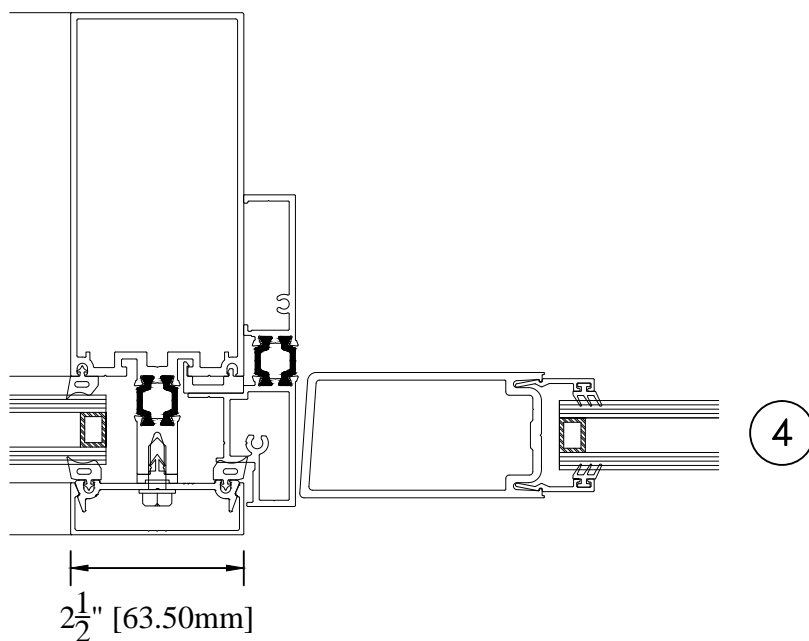

**WINDSPEC** INC.

MANUFACTURERS OF HIGH PERFORMANCE 'WINDSPEC' WINDOWS  
ALUMINUM ENTRANCE SYSTEMS AND ARCHITECTURAL PANELS  
1310 CREDITSTONE RD, CONCORD, ONTARIO L4K 5T7  
Telephone (905) 738 -8311 Fax (905) 738 - 6188

JANUARY 2016

# STANDARD DOOR

## WIDE STILE IN HTP 5500

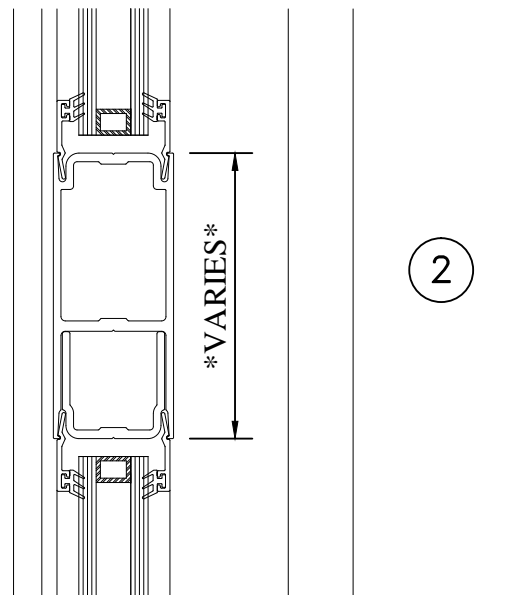
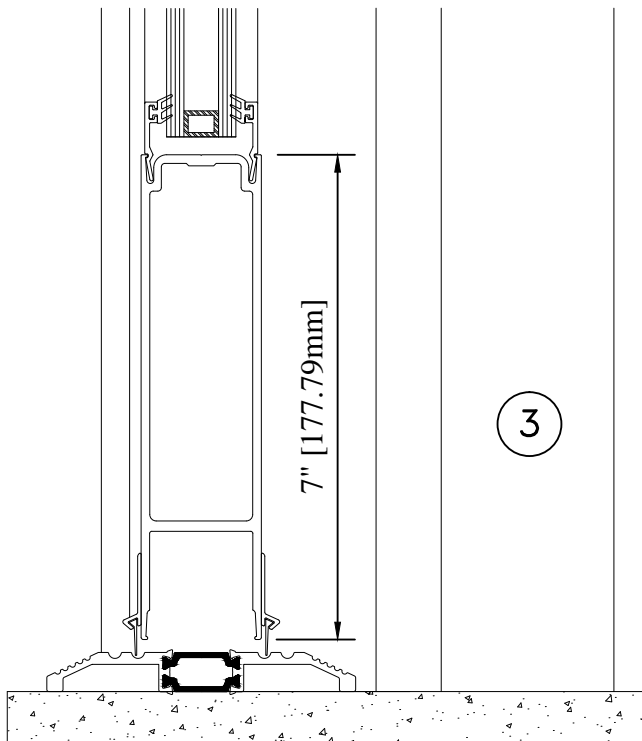
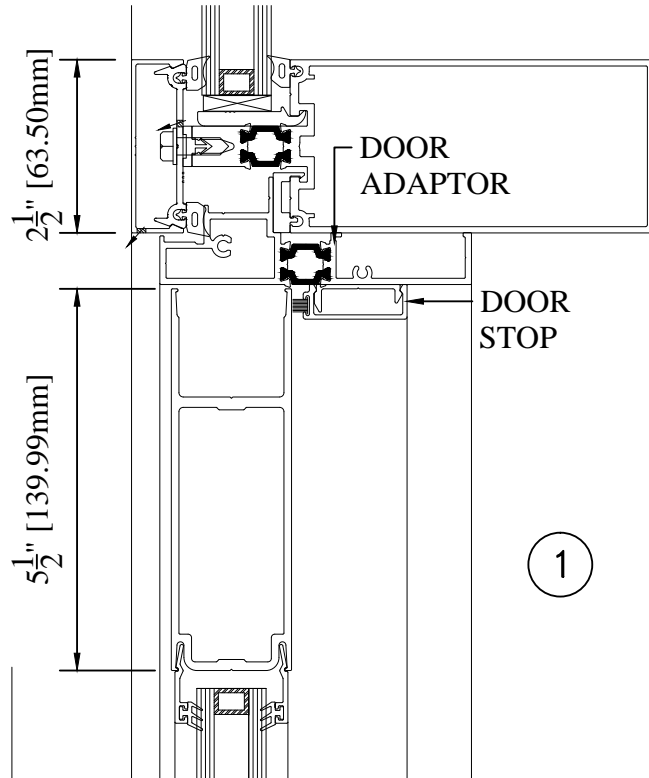
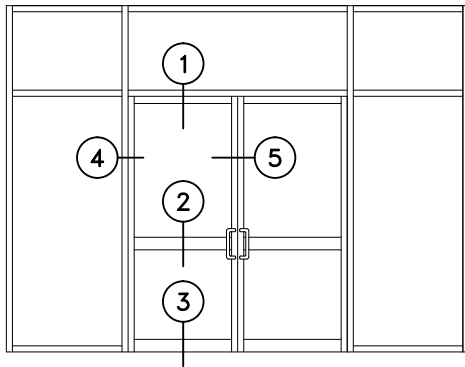

**WINDSPEC** INC.

MANUFACTURERS OF HIGH PERFORMANCE 'WINDSPEC' WINDOWS  
ALUMINUM ENTRANCE SYSTEMS AND ARCHITECTURAL PANELS  
1310 CREDITSTONE RD, CONCORD, ONTARIO L4K 5T7  
Telephone (905) 738 -8311 Fax (905) 738 - 6188

JANUARY 2016

# STANDARD DOOR

## WIDE STILE IN HTP 5500

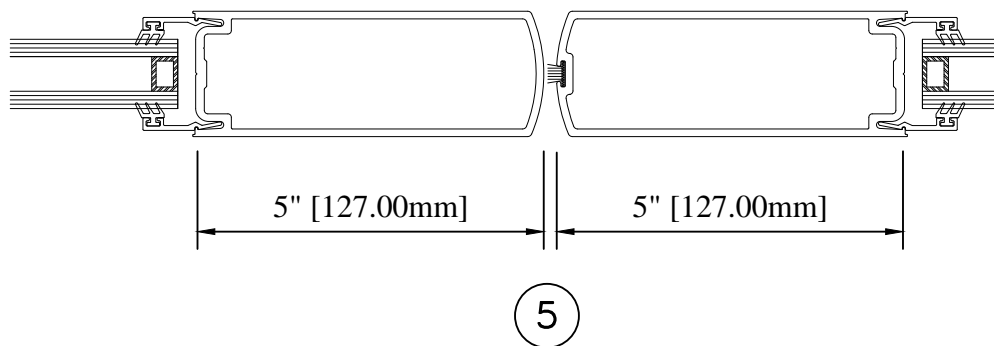
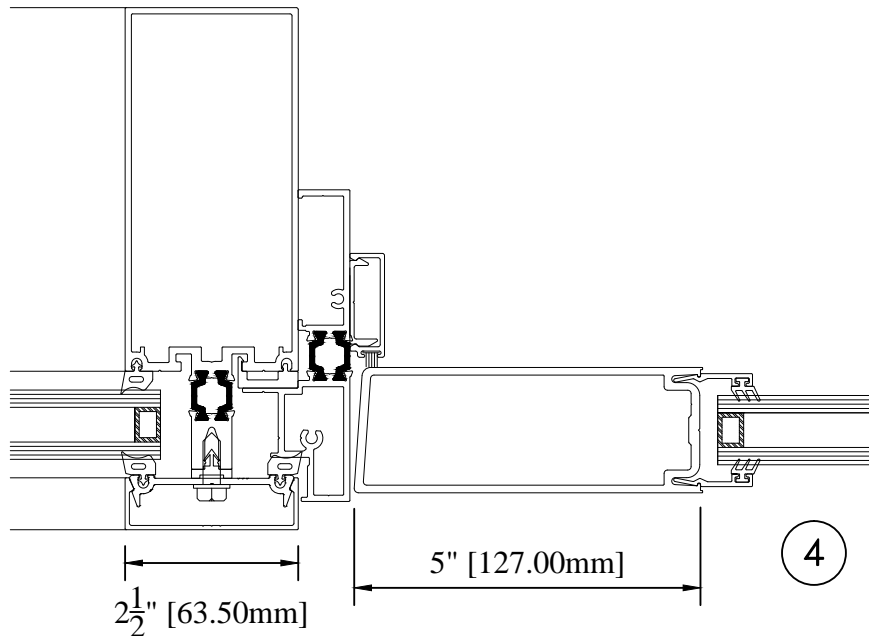

**WINDSPEC** INC.

MANUFACTURERS OF HIGH PERFORMANCE 'WINDSPEC' WINDOWS  
ALUMINUM ENTRANCE SYSTEMS AND ARCHITECTURAL PANELS  
1310 CREDITSTONE RD, CONCORD, ONTARIO L4K 5T7  
Telephone (905) 738 -8311 Fax (905) 738 - 6188

JANUARY 2016

# STANDARD DOOR

## NARROW STILE IN 655 SERIES

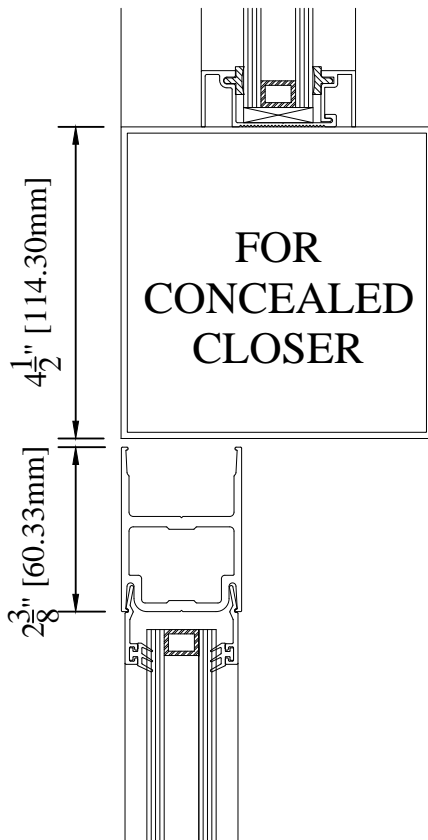
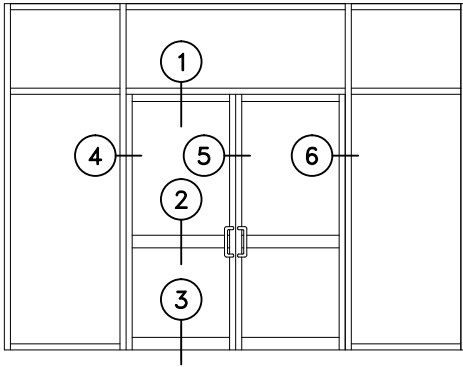

1a

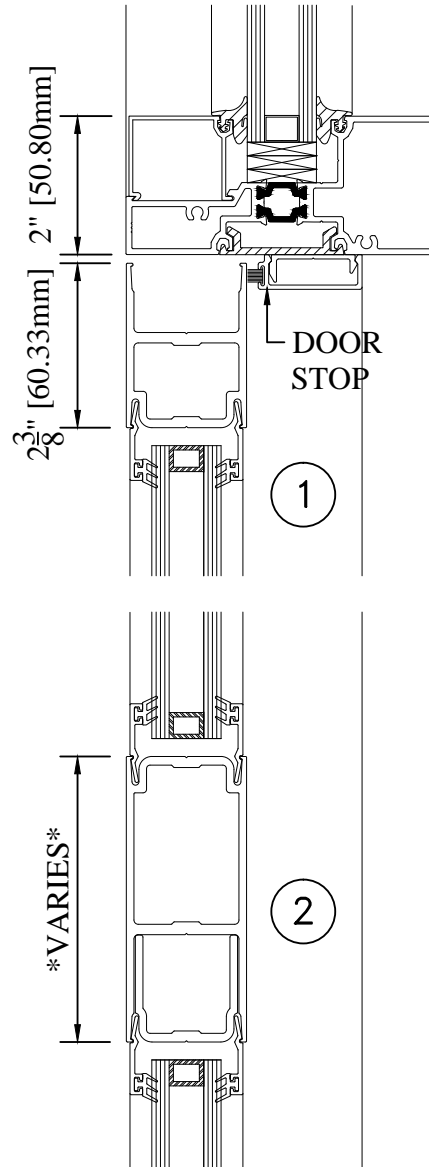

2



**WINDSPEC** INC.  
MANUFACTURERS OF HIGH PERFORMANCE 'WINDSPEC' WINDOWS  
ALUMINUM ENTRANCE SYSTEMS AND ARCHITECTURAL PANELS  
1310 CREDITSTONE RD, CONCORD, ONTARIO L4K 5T7  
Telephone (905) 738 -8311 Fax (905) 738 - 6188

JANUARY 2016

# STANDARD DOOR

## NARROW STILE IN 655 SERIES

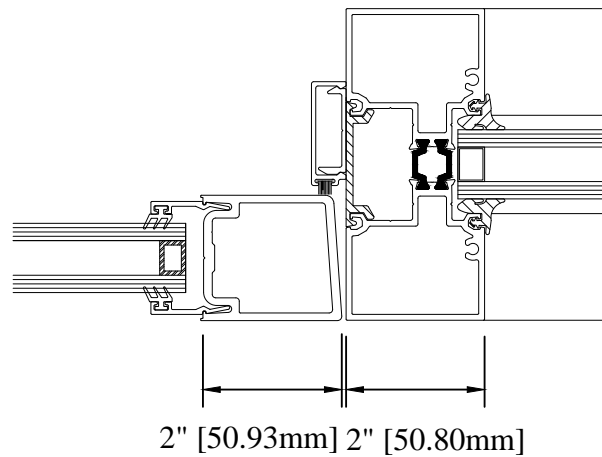
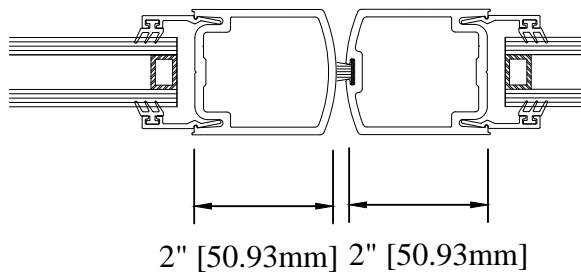
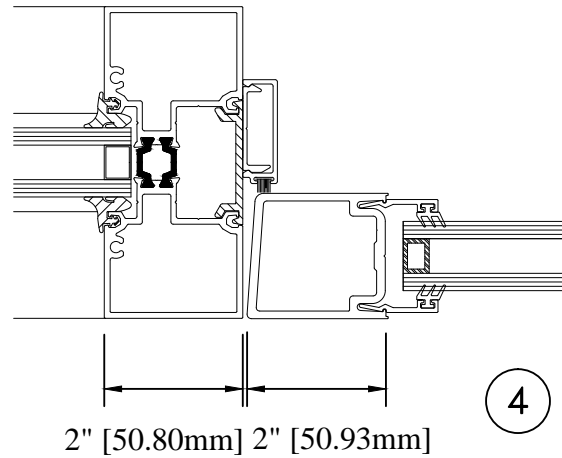
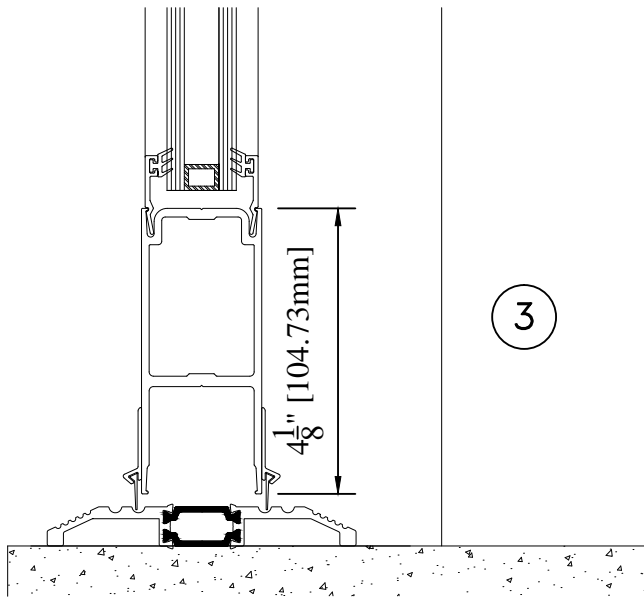

**WINDSPEC** INC.  
MANUFACTURERS OF HIGH PERFORMANCE 'WINDSPEC' WINDOWS  
ALUMINUM ENTRANCE SYSTEMS AND ARCHITECTURAL PANELS  
1310 CREDITSTONE RD, CONCORD, ONTARIO L4K 5T7  
Telephone (905) 738 -8311 Fax (905) 738 - 6188

JANUARY 2016

# STANDARD DOOR

## MEDIUM STILE IN 655 SERIES

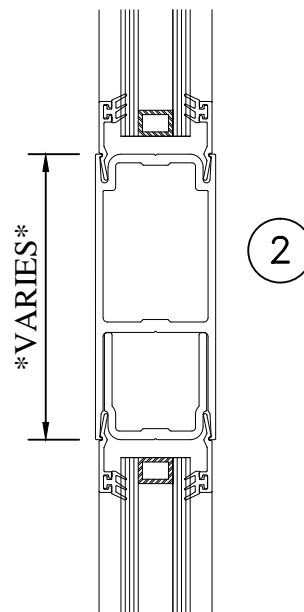
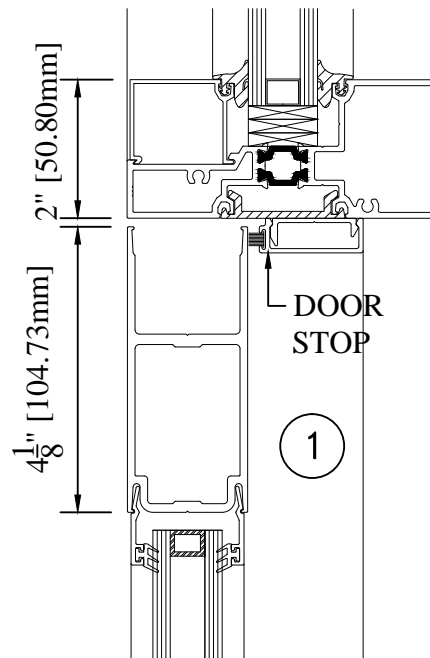
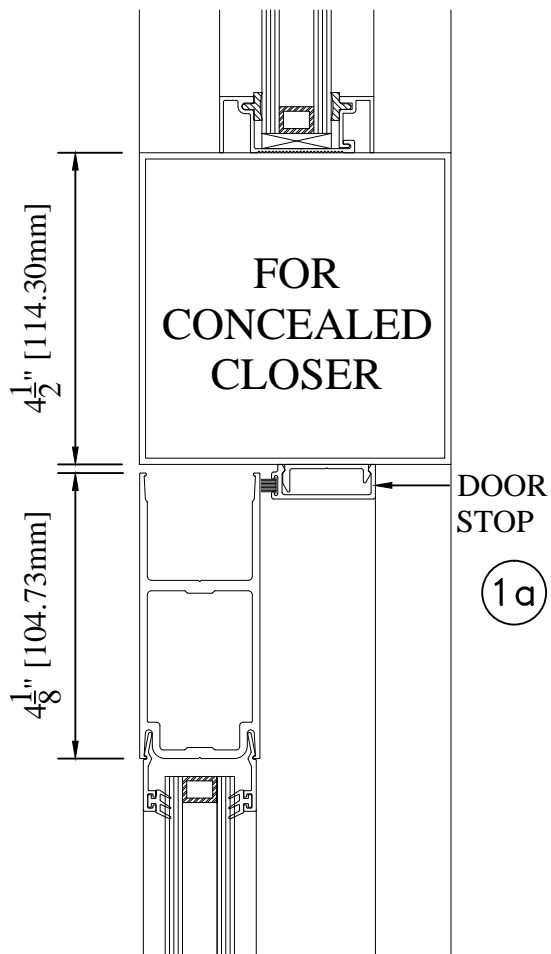
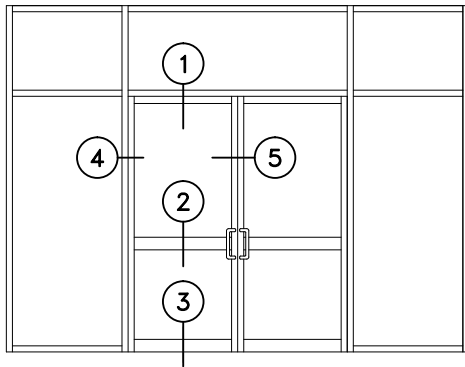

**WINDSPEC** INC.  
MANUFACTURERS OF HIGH PERFORMANCE 'WINDSPEC' WINDOWS  
ALUMINUM ENTRANCE SYSTEMS AND ARCHITECTURAL PANELS  
1310 CREDITSTONE RD, CONCORD, ONTARIO L4K 5T7  
Telephone (905) 738 -8311 Fax (905) 738 - 6188

JANUARY 2016

# STANDARD DOOR

## MEDIUM STILE IN 655 SERIES

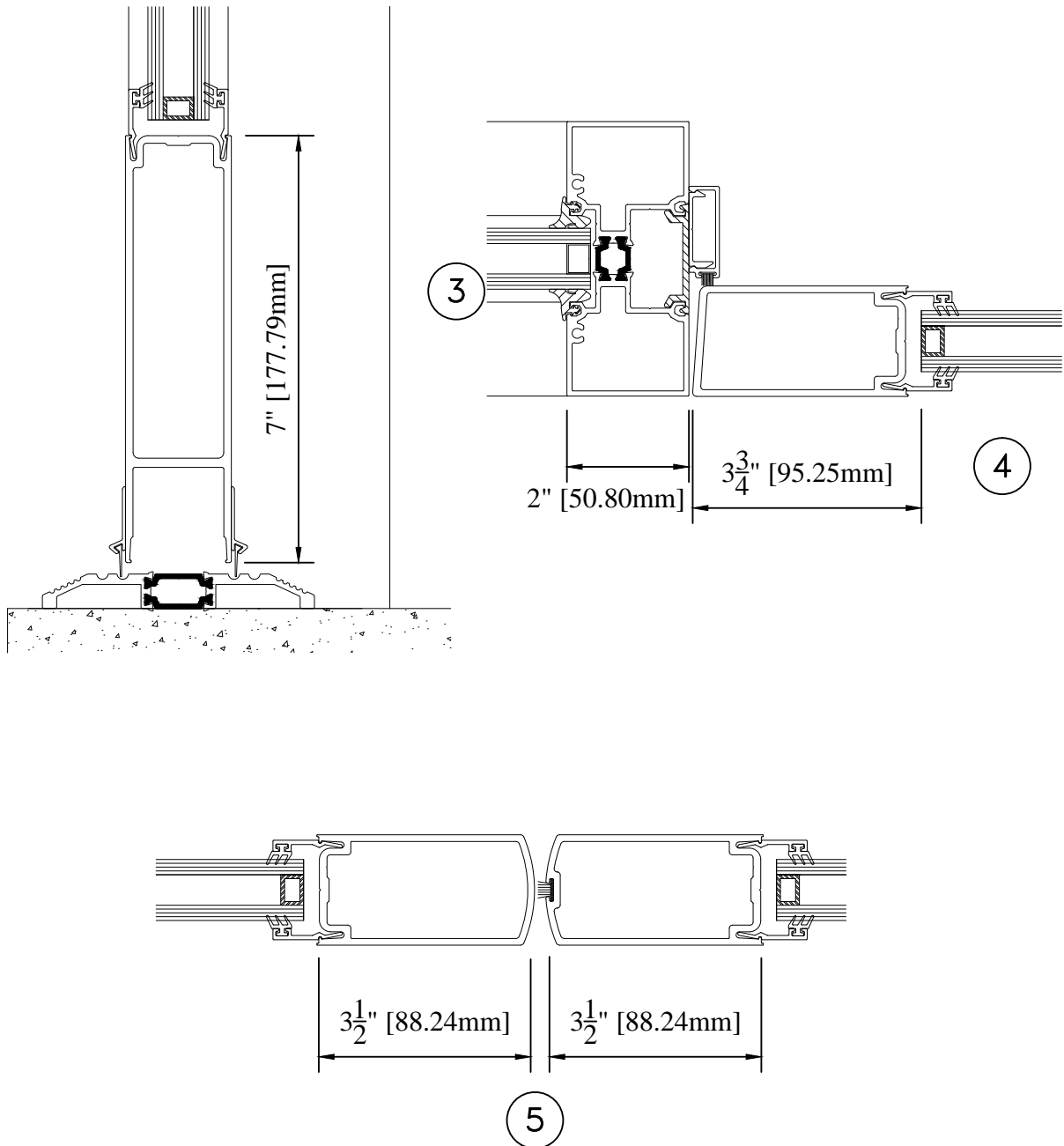

**WINDSPEC** INC.  
MANUFACTURERS OF HIGH PERFORMANCE 'WINDSPEC' WINDOWS  
ALUMINUM ENTRANCE SYSTEMS AND ARCHITECTURAL PANELS  
1310 CREDITSTONE RD, CONCORD, ONTARIO L4K 5T7  
Telephone (905) 738-8311 Fax (905) 738-6188

JANUARY 2016

# STANDARD DOOR

## WIDE STILE IN 655 SERIES

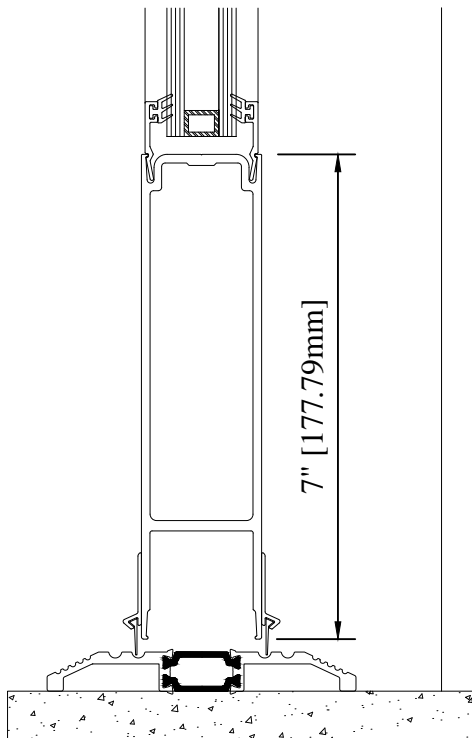
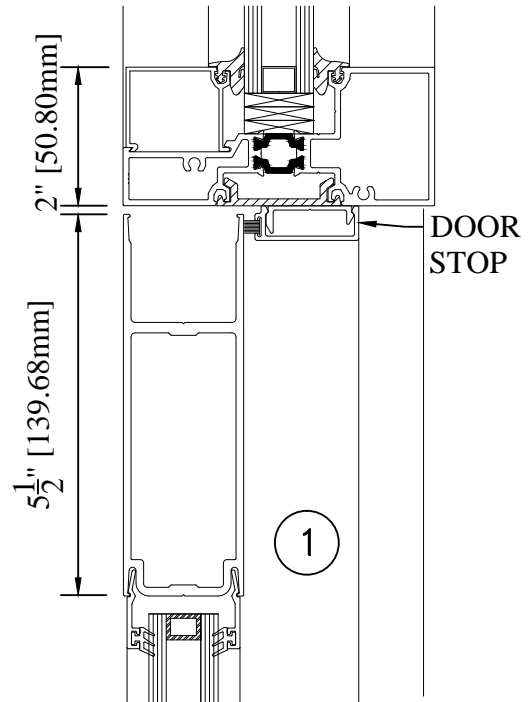
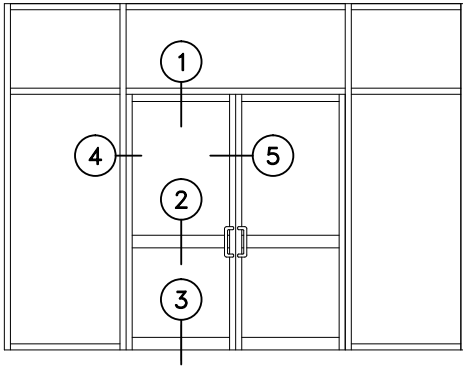

3

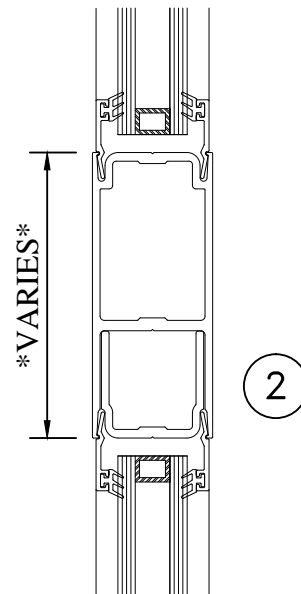

2



**WINDSPEC** INC.

MANUFACTURERS OF HIGH PERFORMANCE 'WINDSPEC' WINDOWS  
ALUMINUM ENTRANCE SYSTEMS AND ARCHITECTURAL PANELS  
1310 CREDITSTONE RD, CONCORD, ONTARIO L4K 5T7  
Telephone (905) 738 -8311 Fax (905) 738 - 6188

JANUARY 2016



# STANDARD DOOR

## WIDE STILE IN 655 SERIES

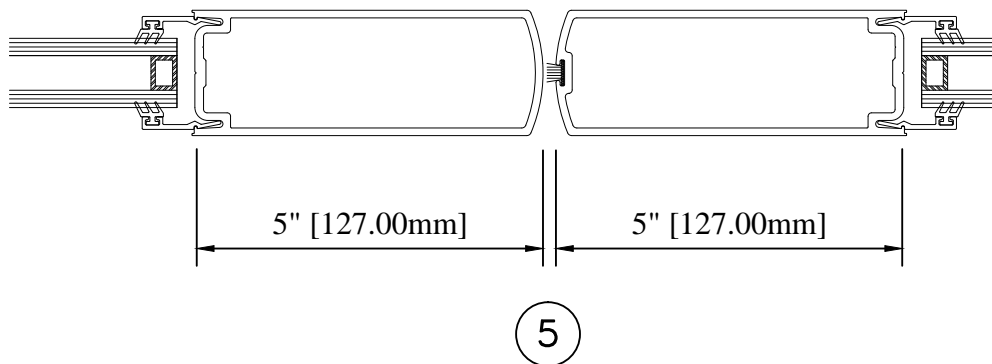
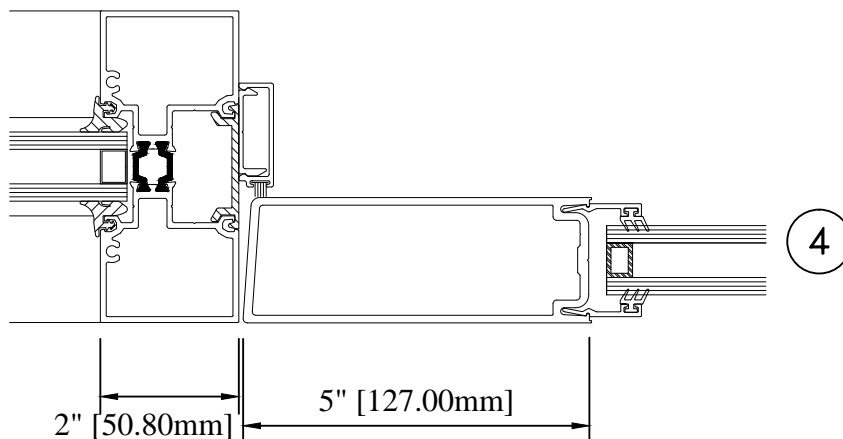

**WINDSPEC** INC.

MANUFACTURERS OF HIGH PERFORMANCE 'WINDSPEC' WINDOWS  
ALUMINUM ENTRANCE SYSTEMS AND ARCHITECTURAL PANELS  
1310 CREDITSTONE RD, CONCORD, ONTARIO L4K 5T7  
Telephone (905) 738 -8311 Fax (905) 738 - 6188

JANUARY 2016

# STANDARD DOOR

## SINGLE GLAZED DOOR IN INTERIOR FRAMING

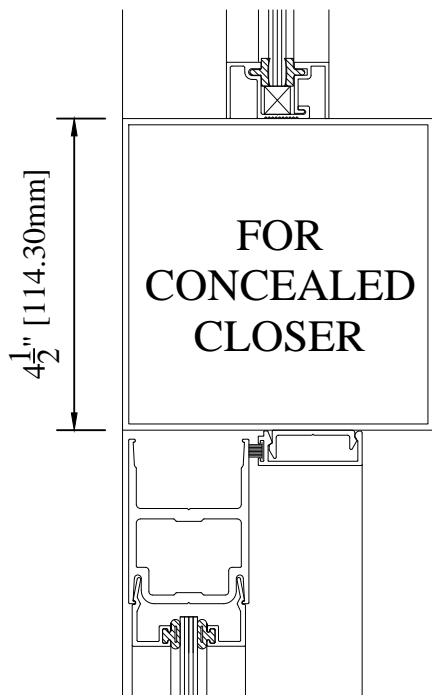
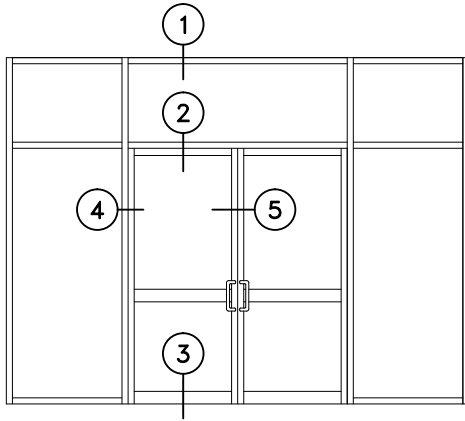

2a

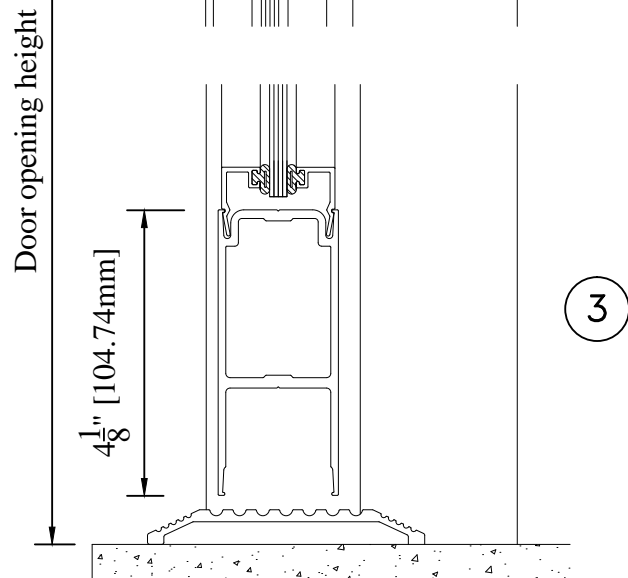
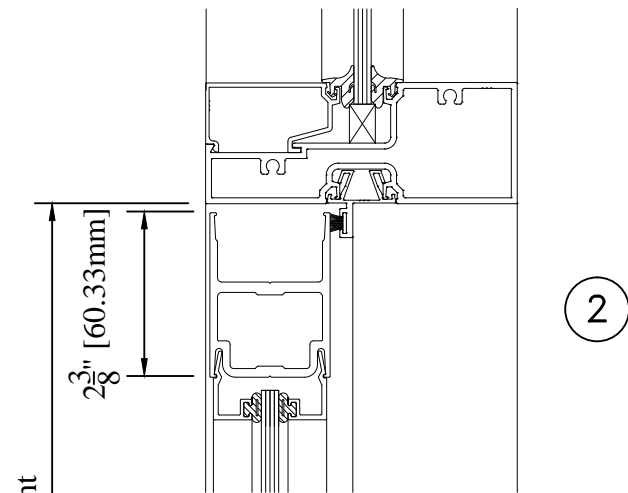
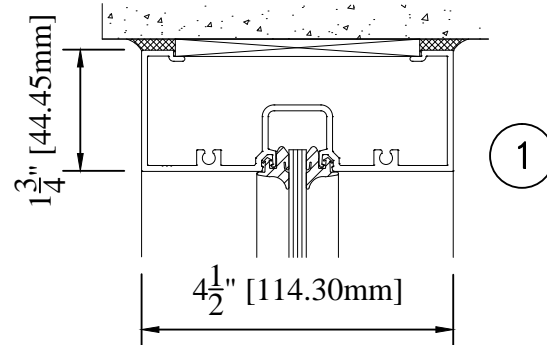

**WINDSPEC** INC.

MANUFACTURERS OF HIGH PERFORMANCE 'WINDSPEC' WINDOWS  
ALUMINUM ENTRANCE SYSTEMS AND ARCHITECTURAL PANELS  
1310 CREDITSTONE RD, CONCORD, ONTARIO L4K 5T7  
Telephone (905) 738 -8311 Fax (905) 738 - 6188

JANUARY 2016

# STANDARD DOOR

## SINGLE GLAZED DOOR IN INTERIOR FRAMING

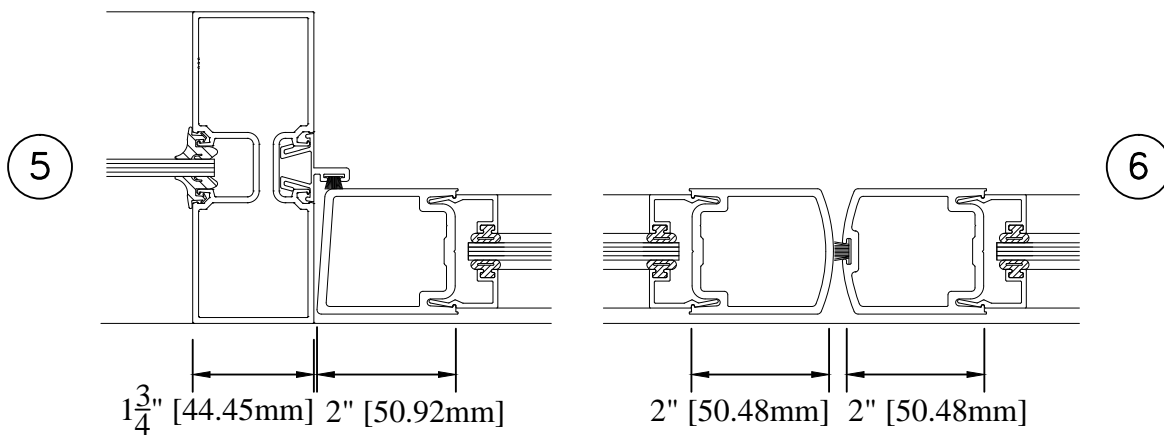

**WINDSPEC** INC.  
MANUFACTURERS OF HIGH PERFORMANCE 'WINDSPEC' WINDOWS  
ALUMINUM ENTRANCE SYSTEMS AND ARCHITECTURAL PANELS  
1310 CREDITSTONE RD, CONCORD, ONTARIO L4K 5T7  
Telephone (905) 738 -8311 Fax (905) 738 - 6188

JANUARY 2016

# STANDARD DOOR

## TOP RAILS, MID-RAILS & BOTTOM RAILS

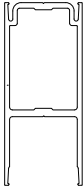
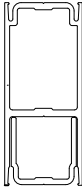
Available Sizes	Top / Bottom Rails 	Intermediate Rails 
1"		*
1 $\frac{3}{4}$ "		*
2 $\frac{3}{8}$ "	*	*
4 $\frac{1}{8}$ "	*	*
5 $\frac{1}{2}$ "	*	*
7"	*	*
8"	*	*
10"	*	*
12"	*	*



**WINDSPEC** INC.

MANUFACTURERS OF HIGH PERFORMANCE 'WINDSPEC' WINDOWS  
ALUMINUM ENTRANCE SYSTEMS AND ARCHITECTURAL PANELS  
1310 CREDITSTONE RD, CONCORD, ONTARIO L4K 5T7  
Telephone (905) 738 -8311 Fax (905) 738 - 6188

JANUARY 2016